

# SOFTWARE CONNECTOR® for JAVA

Linking internally developed systems, third-party software, and legacy applications to the labeling printing infrastructure

The Software Connector for Java serves as a high-speed 'connectivity bridge' between diverse corporate legacy systems and third-party software applications and the Software Print Server®. As a part of the Software Enterprise Label Management Solution, the Connector provides Business Managers and Information Technology Managers with the ability to:

- Centralize control of the label printing function of disparate systems
- Easily integrate internally developed systems, third party or legacy applications into one label printer infrastructure
- Improve label production throughput with no coding changes to label originating applications
- Ensure fast and reliable label production using Software capabilities to support load dividing, automatic failover and clustering; and automatic notification of label printing status
- Deliver increased labeling productivity without disrupting current business operations or retraining the existing end-users
- Offload the resource intensive task of creating and printing labels from business-critical applications to deliver better system performance
- Eliminate maintenance programming and keep current with changing labeling demands by using the Connector's powerful set of business logic tool sets

## Java Connectivity to the Broadest Range of Applications and Data Sources

The Software Connector for Java links a vast range of applications with the Software Print Server (or multiple Software Print Servers) to deliver the right label to the right printer at the right time. The Software Connector for Java can process label print requests from any application via customer written Java code. It can also obtain any required label data from any JDBC Compliant Data Source.

## File Drop Connectivity to Legacy Systems and Third-Party Software Packages

The Software Connector for Java also includes a File Drop capability that enables it to receive and process label print request files sent to it by any application. File types supported are XML, PAS, CSV and XSLT. As most software applications possess the ability to create files in one or more of these file formats and to send files to another application, the File Drop capability minimizes or even eliminates the programming effort normally required to create label print request files. The Software Connector for Java, at customer-configurable intervals (usually in milliseconds), sweeps a designated

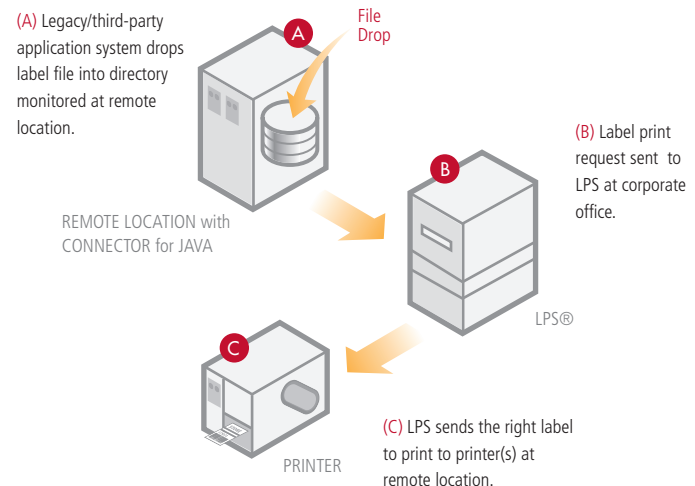

Scan Folder for label print request files, processes the contents, and sends the processed data to the appropriate Software Print Server for printing.

## High Throughput Label Production

The Software Connector for Java enhances the processing of label print requests by way of a 'High Speed' Queuing System and supports label printing on a 'large to massive' scale –100's to 1000's of printers.

## LOFTWARE CONNECTOR® for JAVA®

### Intelligent Data Filtering and Decision-Making Tools

The Loftware Connector for Java incorporates filtering that addresses all of the special business logic associated with corporate label output management systems without having to change the originating applications through additional programming or customization. The basic function of a Filter is to find and add missing data to a request coming from a Label Print Request. The Loftware Connector for Java Filters makes it possible to:

- Get up and running in a shorter time frame
- Centralize and develop Business Logic in one place
- Provides flexibility to ever-changing business requirements
- Maintain Business Logic through a highly configurable interface, eliminating programming tasks

From a single Label Print Request, the Loftware Connector for Java enables you to print multiple label formats, use multiple printer types, and automatically determine which label or labels to print and how and where to print them.

### What Happens If A Label Print Request Does Not Include All Of The Required Data?

A very powerful feature of the Loftware Connector for Java is its ability to be configured to dynamically retrieve label content data that is not included in the Label Print Request. The Loftware Connector for Java will retrieve the additional label content data from the originating application database and/or from any other application or database.

### Technical Support

Loftware backs its product offerings with a team of industry professionals dedicated to delivering outstanding technical support. Also available from the Loftware website are downloadable upgrades and documentation.

### PRODUCT FEATURES

- Supports transaction or process initiated printing from any application via customer written Java code or by utilizing the File Drop interface
- Requires Java2EE SDK Version 1.4 and J2SE SDK Version 1.4.2x or Java J2EE SDK Version 5 and J2SE SDK Version 5
- Supports File Drop initiated label printing from any application that can generate XML, PAS, CSV or XSLT files
- Requires Java Runtime Environment for File Drop
- A single Loftware Connector for Java can support multiple Loftware Print Servers for load dividing and clustering to deliver optimum label production throughput
- Label print requests from one application can be enhanced using Business Filters to obtain label content data from multiple applications
- Multiple print requests are queued for each target printer with full error recovery, status and guaranteed delivery
- High-Speed TCP/IP Socket connectivity with Loftware Print Servers results in the rapid processing of label print requests and ensures high label production throughput

## LOFTWARE

166 Corporate Drive, Portsmouth, NH 03801

Tel: (603) 766-3630 • Fax: (603) 766-3631 • [www.loftware.com](http://www.loftware.com)

©2007-2008 Loftware, Inc. All Rights Reserved. Loftware, Loftware Print Server, LPS, Loftware Label Manager, LLM, and Loftware Connector are registered trademarks of Loftware, Inc. All other trademarks are the property of their respective owners.